

Skyrocket your efficiency

This flexible device is an all-in-one solution for medium and large-sized work groups, offering everything from double-sided print to copying, scanning and faxing. Our open solution platform, HyPAS, enables powerful customisations for specific tasks while the Single Pass Duplex scanning feeder ensures problem-free and rapid scanning.

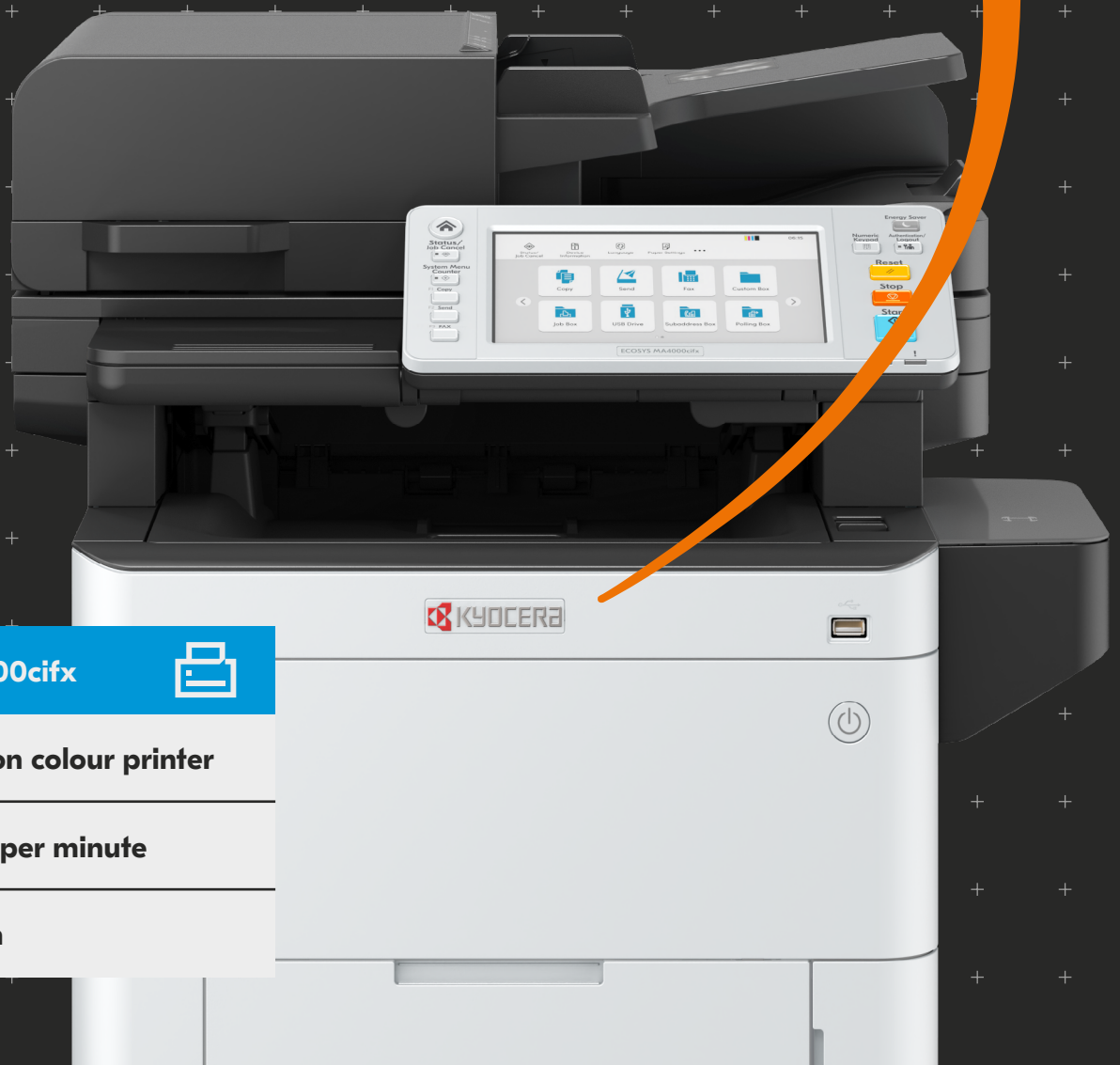

ECOSYS MA4000cfx



A4 multi-function colour printer

Up to 40 pages per minute

Compact design

Specifications

GENERAL

KYOCERA ECOSYS Laser Colour Multifunctional HyPAS™ solution platform
Operation panel: 177.8 mm (7 inch) full-colour touch panel display, speaker for job notification
Type: Desktop
Engine speed Simplex: Up to 40 pages A4 per minute.
Engine speed Duplex: Up to 20 pages A4 per minute.
Duplex copy speed: Up to 17 pages A4 per minute.
Resolution: 1200 x 1200 dpi (print); 600 x 600 dpi (scan/copy)
Recommended Print Volume: 1,900 images per month.
Maximum Life: 600,000 images or 5 years.
Scan Volume: max. 6,000 pages per month.
Warm-up time: Approx. 26 seconds or less.
Time to first print: Approx. 5.4 seconds or less.
Time to first copy: Approx. 6.2 or less (DP); Approx. 5.8 or less (Platen).
CPU: ARM Cortex-A9 Dual core 1.2GHz
Memory: Standard 2GB; Max. 3GB (optional).
Standard interfaces: USB 2.0 (Hi-Speed), 2 x USB Host Interface, Gigabit Ethernet (10BASE-T/100BASE-TX/1000BASE-T), optional Wireless LAN (IEEE 802.11b/g/n), 1 x eKUIO slot for optional devices other than FAX, Slot for optional SD Card
Integrated accounting: 100 department codes
Dimensions (W x D x H): Without packaging: 480 x 577.5 x 571.5 mm (without protrusions); 480 x 577.5 x 575 mm (including protrusions); With packaging: 623 x 728 x 789 mm
Weight: Without packaging: Approx. 39 kg (with bundled toner) Approx. 38 kg (without bundled toner) With packaging: 51 kg
Power source: AC 220 ~ 240 V, 50/60 Hz
Power consumption:
Printing: 573.6 W
Copying: 575.0 W
Ready mode: 18.8 W
Sleep-mode: 0.5 W
Noise (sound pressure level: ISO 7779/ISO 9296):
Operating: 53 dB (LpAm)
Stand-by: 30 dB (LpAm)
Safety standards: TÜV/GS, CE
This unit is manufactured according to ISO 9001 quality standard and ISO 14001 environmental standard.

PAPER HANDLING

All paper capacities quoted are based on paper thickness of max. 0.11 mm. Please use paper recommended by KYOCERA under normal environmental conditions.
Input capacity: Multi-purpose tray: 100 sheets (80 g/m² equivalent), 110 sheets (64 g/m² equivalent), 60–220 g/m² A4, A5, A6, B5, B6, Letter, Legal, Folio, Custom (70 x 140 to 216 x 356 mm), Banner paper up to 1220 mm. Standard universal paper cassette: 250 sheet with 75 g/m²; 300 sheet with 64 g/m². 60–220 g/m². A4, A5, A6, B5, B6, Letter, Legal, Folio, Custom (105 x 140 to 216 x 356 mm). Max. input capacity with options: 2,050 sheets with 75 g/m², 2,210 sheets with 64 g/m²
Duplex: Standard duplex unit, 60–163 g/m², A4, A5, B5, Letter, Legal, Custom (140x 210 mm - 216 x 356 mm).
Document Processor: Dual scan document processor as standard, 100 sheets, 50–120 g/m², A4, A5, A6, B5, Letter, Legal, Custom (105 x 148 to 216 x 356 mm).
Output capacity: 250 sheets (Equivalent to 80 g/m²) face down with paper full sensor

PRINT FUNCTIONS

Controller language: PRESCRIBE
Emulations: PCL6 (5c/XL), KPDL3 (PostScript 3 compatible), PDF, XPS, Open XPS, TIFF, JPEG, URF, PWG Raster, PCLm
Operating systems: All current Windows operating systems, MAC OS X Version 10.9 or higher, Chrome OS, Linux, as well as other operating systems on request.
Fonts/barcodes: 93 outline fonts (PCL6, KPDL3), 4 fonts (Calibri), 4 fonts (Cambria), 1 Bitmap font, 45 types of one-dimensional barcodes, 1 type of two-dimensional barcode (PDF417).
Print features: PDF Direct Print, Internet printing IPP 1.0, E-mail printing, WSD print, secure printing IPP over TLS, Local and network authentication, Network data encryption IPsec, HTTPS, LDAP over TLS, SNMPv3, SMTP over TLS, POP over TLS, Encrypted PDF Direct Print, TLS 1.3, Secure Boot, Run-time Integrity Check, Microsoft Universal Print, Printing for Chrome OS
Mobile printing support: KYOCERA Mobile Print app for iOS and Android, AirPrint, Mopria, Microsoft Universal Print, Wi-Fi Direct (Opt).

COPIY FUNCTIONS

Max. original size: A4/Legal.
Continuous copying: 1–999.
Zoom range: 25–400% in 1% steps.
Preset magnification ratios: 5 Reductions / 5 Enlargements.
Image adjustments: Text + Photo, Photo, Text, Chart/Map, Printed document.
Features: Electronic sort (collate), ID card copy, 2in1, 4in1, auto cassette change, Skip blank page, Skip Line, DP Auto-cropping

SCAN FUNCTIONS

Functionality: Scan-to-Email, Scan-to-FTP, Scan-to-SMB, Scan to USB Host, Network TWAIN, WIA, WSD scan, Chrome OS (Scan), AirPrint, Mopria.
Scan speed Simplex: 60 ipm (300 dpi, A4, b/w); 50 ipm (300 dpi, A4 colour)
Scan speed Duplex: 120 ipm (300dpi, A4, b/w); 100 ipm (300 dpi, A4, colour)
Scan resolution: 300 dpi x 300 dpi, 200 dpi x 200 dpi (Default) , 200 dpi x 100 dpi, 600 dpi x 600 dpi , 400 dpi x 400 dpi , 200 dpi x 400 dpi, 1200dpix1200dpi (TWAIN driver, WIAdriver). 256 greyscales per colour
Max. scan size: A4, Legal, Banner paper (max 915mm).
Original recognition: Text, photo, text + photo, light text, optimised for OCR
File types: TIFF (MMR/JPEG compression), JPEG, XPS, Open XPS, PDF (MMR/JPEG compression), PDF/A-1, PDF/A-2, PDF (High compression), Encrypted PDF, MS Office file (Opt), Searchable PDF (Opt)
Features: Banner Scan, Colour scan, integrated address book, Active Directory support, encrypted data transfer, multi send (e-mail, fax, SMB/FTP folder, print) at once, Blank page skip, Border Erase, Digital Signature (Require SSD), DP Auto Crop

FAX FUNCTIONS

Compatibility: Super G3.
Modern speed: Max. 33.6 kbps.
Transmission speed: Max. 3 seconds (JBIG).
Scanning speed: 2.5 seconds or less.
Address book: Personal 200 entries, Group 50 entries
Scanning density:
Normal: 8 dot/mm x 3.85 line/mm (200 x 100 dpi)
Fine: 8 dot/mm x 7.7 line/mm (200 x 200 dpi)
Superfine: 8 dot/mm x 15.4 line/mm (200 x 400 dpi)
Ultrafine: 16 dot/mm x 15.4 line/mm (400 x 400 dpi)

Halftone: 256 grey scales
Original size: A4, Legal, A6, Banner (max 915mm)
Compression method: JBIG, MMR, MR, MH
Memory reception: 256 sheets or more
Features: Network fax, duplex transmission and reception, encrypted transmission and reception, polling transmission and reception, broadcast.

CONSUMABLES

Average continuous toner yield in accordance with ISO 19798
TK-5384K: Black 13,000 pages
TK-5384Y, TK-5384M, TK-5384C: Yellow, Magenta and Cyan 10,000 pages A4.
Starter toner black 6,000 pages and Yellow, Magenta and Cyan 5,000 pages A4.

OPTIONS

PF-5150 Paper feeder: Max. 550 sheet with 75 g/m², 600 sheet with 64 g/m², 60 – 220 g/m², A5R – Legal, 92.1 x 165.1 (Com6), 114x162 (Youkei2), Max 3 Units
1244/10 Cabinet: for 2-draw configuration
Memory upgrade: 1GB
Storage Devices for easy document management:
HD-17 SSD hard disk: 64GB
HD-18 SSD hard disk: 256GB
HD-19 SSD hard disk: 512GB
Scan Extension Kit (A): Scan to searchable PDF (embedded OCR) or to MS Office (docx, xlsx, pptx), HD or SD card is needed.

SECURITY OPTIONS

UG-33 AC: ThinPrint support
UG-35: TPM (Trusted Platform Module)
USB IC Card Reader + Card Authentication Kit (B): Support for various authentication keys available.
CRH 12: Card Reader Holder 12
Optional interface:
IB-37: Wireless LAN (802.11a/b/g/n/ac) with Wi-Fi Direct
IB-50: Gigabit Ethernet 10BASE-T/100BASE-TX/1000BASE-T
IB-51: Wireless LAN interface (802.11b/g/n)

WARRANTY

2 years on-site as standard.

WHAT'S IN THE BOX:

Main unit, starter toner, waste toner box, Quick guide, Safety Guide, Operation panel sheet , power supply cord.

ECOSYS stands for ECOlogy, ECONomy and SYStem printing. With their long-life components, ECOSYS devices are designed to maximise durability and minimise the total cost of ownership with regard to maintenance, administration and consumables. The cartridge-free system means that only the toner has to be replaced regularly. The modular design concept allows you to add workflowenhancing functions as required. Integrated system software provides long-term crossnetwork compatibility. KYOCERA's long-life components cost you and the environment less.

HyPAS™



KYOCERA Document Solutions Partner

JUN2023MA4000cifix/VER1.0

KYOCERA Document Solutions Australia

Ph: 13 59 62

www.kyoceradocumentsolutions.com.au

KYOCERA Document Solutions New Zealand

Ph: 0800 459 623

www.kyoceradocumentsolutions.co.nz



* KYOCERA Document Solutions does not warrant that any specifications mentioned will be error-free. Specifications are subject to change without notice. Information is correct at time of going to press. All other brand and product names may be registered trademarks or trademarks of their respective holders and are hereby acknowledged.
** Depending on the country