

P SERIES MONITORS

DELL 24 AND 27 MONITORS – P2423D, P2723D

See and accomplish more

Enhance work efficiency with QHD (2560 x 1440) resolution on a 23.8" or 27" monitor.

Color consistency comes standard

See consistent, vibrant colors across a wide viewing angle enabled by In-Plane Switching (IPS) technology. With 99% sRGB coverage, you get precise colors right out of the box.

Extensive connectivity

Easily connect to a variety of devices with extensive connectivity ports, including display port, HDMI, and quick access SuperSpeed 5Gbps USB ports.

Functional design

Features 3-sided ultrathin bezel design, a small base and improved cable management for a clutter free desk at your home or at your office.



Optimize eye comfort with built-in **ComfortView Plus** that reduces harmful blue light emissions without sacrificing color performance.

Adjust to your comfort

Tilt, swivel, pivot, and height adjustable (150mm max)

Environmental standards

ENERGY STAR®
TCO Certified Edge,
EPEAT® Gold registered

Easy-to-use joystick control

To navigate through the On-Screen Display (OSD) menu

THE WORLD'S # 1 MONITOR COMPANY*



* Dell monitors are #1 Worldwide for 8 consecutive years (2013, Q2 to 2021, Q3)! Source: IDC Worldwide Quarterly PC Monitor Tracker, Q3, 2021.

P SERIES MONITORS

P2423D, P2723D



STEADFAST RELIABILITY

Peace of mind

Dell Premium Panel Exchange¹ allows a free monitor replacement during the Limited Hardware Warranty² period, even if only one bright pixel is found.

Minimize downtime

Your monitor comes with a 3-year Advanced Exchange Service³ so that if a replacement becomes necessary, it will be shipped to you the next business day during your 3-year Limited Hardware Warranty.²

Get a higher level of support

Upgrade to 24x7 specialized technical phone support with the Dell ProSupport option.⁴

RECOMMENDED ACCESSORIES



Dell Single Monitor Arm | MSA20

Enjoy a virtually tool-free assembly and easy installation with this Dell Single Monitor Arm – MSA20. Dell Quick Release lets you snap on the Dell P Series monitor onto the arm simply without tools.



Dell Pro Wireless Headset | WL5022

Enjoy wireless freedom away from your PC with this Teams certified headset that offers convenient call controls. Switch seamlessly across your PC, tablet or smartphone and enjoy superior audio clarity on the go.



Dell Premier Multi-Device Wireless Keyboard and Mouse | KM7321W

Multitask seamlessly across three devices with this premium full-sized keyboard and sculpted mouse combo with programmable shortcuts and 36-month battery life.⁵

¹ Applicable to Dell UltraSharp, P Series, and C Series desktop monitors.

² For copy of Ltd Hardware Warranty, write to Dell USA LP, Attn: Warranties, One Dell Way, Round Rock, TX 78682 or see <https://www.dell.com/warranty>.

³ Advanced Exchange: Dell will send you a replacement monitor the next business day in most cases if deemed necessary after phone/online diagnosis. Shipping times may vary by location and for monitors 55" and above. Fee charged for failure to return defective unit. See dell.com/servicecontracts/global.

⁴ Availability varies, please visit www.dell.com/support for details. In some countries, hours for in-region support may vary. Support after local business hours may be provided in a language other than the local language.

⁵ Based on Dell analysis of battery life usage model calculations, Nov. 2020. Results vary depending on use, operating conditions and other factors.

P SERIES MONITORS

P2423D, P2723D

DELL 24 MONITOR – P2423D TECHNICAL SPECIFICATION

DIAGONAL VIEWING SIZE	604.50 mm (23.80 inches)
PRESET DISPLAY AREA (H X V)	526.85 mm x 296.35 mm (20.74 in. x 11.67 in.)
MAXIMUM PRESET RESOLUTION	2560 x 1440 at 60 Hz
ASPECT RATIO	16:9
PIXEL PITCH	0.2058 mm x 0.2058 mm
PIXEL PER INCH (PPI)	123
BRIGHTNESS	300 cd/m ² (typical)
COLOR SUPPORT	Color gamut: sRGB 99% (typical) Color depth: 16.7 Million
CONTRAST RATIO	1000:1 (typical)
VIEWING ANGLE	178°/178°
RESPONSE TIME	5 ms (Fast mode), 8 ms (Normal mode)
PANEL TYPE	In-Plane Switching Technology
DISPLAY SCREEN COATING	Anti-Glare
BACKLIGHT TECHNOLOGY	White LED edgelight system
COMFORTVIEW PLUS WITH FLICKER-FREE SCREEN	Yes
DELL DISPLAY MANAGER COMPATIBILITY	Yes
REMOTE ASSET MANAGEMENT	Yes, via Dell Command Monitor
GSA/TAA	Yes
OPTIONAL SOUNDBAR	SB521A or SB522A
CONNECTORS	<ul style="list-style-type: none"> · 1 x HDMI 1.4 (HDCP 1.4) · 1 x DisplayPort 1.2 (HDCP 1.4) · 1 x USB 3.2 Gen1 upstream · 4 x SuperSpeed USB 5Gbps (USB 3.2 Gen1) downstream
HDCP SUPPORT	HDMI HDCP 1.4, DP HDCP 1.4
ADJUSTABILITY	Height adjustable (150 mm) Tilt (-5° to 21°) Swivel (-45° to 45°) Pivot (-90° to 90°)
SECURITY	Security lock slot (cable lock sold separately)
FLAT PANEL MOUNT INTERFACE	VESA (100 mm)
AC INPUT VOLTAGE/FREQUENCY/CURRENT	100 VAC to 240 VAC / 50 Hz or 60 Hz ± 3 Hz / 1.5 A (typical)
POWER CONSUMPTION (OPERATIONAL)	0.3 W (Off mode) ¹ 0.3 W (Standby Mode) ¹ 16 W (On Mode) ¹ 55 W (Max.) ²
POWER CONSUMPTION STAND BY/SLEEP	Less than 0.3W
HEIGHT WITH STAND	496.11 mm (19.53 in.)
WIDTH WITH STAND	537.80 mm (21.17 in.)
DEPTH WITH STAND	179.57 mm (7.07 in.)
WEIGHT (PANEL ONLY - FOR VESA MOUNT/ NO CABLES)	3.44 kg (7.58 lb)
WEIGHT (MONITOR AND CABLES WITH STAND)	5.45 kg (12.02 lb)
WEIGHT (WITH PACKAGING)	7.44 kg (16.40 lb)

DELL 27 MONITOR – P2723D TECHNICAL SPECIFICATION

DIAGONAL VIEWING SIZE	684.70 mm (26.96 inches)
PRESET DISPLAY AREA (H X V)	596.74 mm x 335.66 mm (23.49 in. x 13.21 in.)
MAXIMUM PRESET RESOLUTION	2560 x 1440 at 60 Hz
ASPECT RATIO	16:9
PIXEL PITCH	0.2331 mm x 0.2331 mm
PIXEL PER INCH (PPI)	109
BRIGHTNESS	350 cd/m ² (typical)
COLOR SUPPORT	Color gamut: sRGB 99% (typical) Color depth: 16.7 Million
CONTRAST RATIO	1000:1 (typical)
VIEWING ANGLE	178°/178°
RESPONSE TIME	5 ms (Fast mode), 8 ms (Normal mode)
PANEL TYPE	In-Plane Switching Technology
DISPLAY SCREEN COATING	Anti-Glare
BACKLIGHT TECHNOLOGY	White LED edgelight system
COMFORTVIEW PLUS WITH FLICKER-FREE SCREEN	Yes
DELL DISPLAY MANAGER COMPATIBILITY	Yes
REMOTE ASSET MANAGEMENT	Yes, via Dell Command Monitor
GSA/TAA	Yes
OPTIONAL SOUNDBAR	SB521A or SB522A
CONNECTORS	<ul style="list-style-type: none"> · 1 x HDMI 1.4 (HDCP 1.4) · 1 x DisplayPort 1.2 (HDCP 1.4) · 1 x USB 3.2 Gen1 upstream · 4 x SuperSpeed USB 5Gbps (USB 3.2 Gen1) downstream
HDCP SUPPORT	HDMI HDCP 1.4, DP HDCP 1.4
ADJUSTABILITY	Height adjustable (150 mm) Tilt (-5° to 21°) Swivel (-45° to 45°) Pivot (-90° to 90°)
SECURITY	Security lock slot (cable lock sold separately)
FLAT PANEL MOUNT INTERFACE	VESA (100 mm)
AC INPUT VOLTAGE/FREQUENCY/CURRENT	100 VAC to 240 VAC / 50 Hz or 60 Hz ± 3 Hz / 1.5 A (typical)
POWER CONSUMPTION (OPERATIONAL)	0.3 W (Off mode) ¹ 0.3 W (Standby Mode) ¹ 21 W (On Mode) ¹ 55 W (Max.) ²
POWER CONSUMPTION STAND BY/SLEEP	Less than 0.3W
HEIGHT WITH STAND	535.20 mm (21.07 in.)
WIDTH WITH STAND	611.60 mm (24.08 in.)
DEPTH WITH STAND	190.10 mm (7.48 in.)
WEIGHT (PANEL ONLY - FOR VESA MOUNT/ NO CABLES)	4.54 kg (10.01 lb)
WEIGHT (MONITOR AND CABLES WITH STAND)	6.76 kg (14.90 lb)
WEIGHT (WITH PACKAGING)	9.20 kg (20.28 lb)

¹ As defined in EU 2019/2021 and EU 2019/2013.

² Max brightness and contrast setting with maximum power loading on all USB

P SERIES MONITORS

P2423D, P2723D

DELL 24 MONITOR – P2423D TECHNICAL SPECIFICATION

STANDARD SERVICE PLAN 3 Years Advanced Exchange Service and Limited Hardware Warranty

OPTIONAL SERVICE PLAN Dell ProSupport

ENVIRONMENTAL COMPLIANCE

- ENERGY STAR® certified monitor.
- EPEAT® registered where applicable. EPEAT registration varies by country. See www.epeat.net for registration status by country.
- RoHS-compliant
- TCO Certified & TCO Certified Edge
- BFR/PVC free monitor (excluding external cables)
- Meets NFPA 99 leakage current requirements
- Arsenic-free glass and Mercury-free for the panel only

WHAT'S INCLUDED

- Monitor with stand
- 1 x Power cable
- 1 x DisplayPort to DisplayPort cable (1.8 m)
- 1 x SuperSpeed USB 5Gbps (USB 3.2 Gen1) Type-A to Type-B upstream cable (enables the USB ports on the monitor)
- Quick Setup Guide
- Safety and regulatory information

DELL 27 MONITOR – P2723D TECHNICAL SPECIFICATION

3 Years Advanced Exchange Service and Limited Hardware Warranty

Dell ProSupport

- ENERGY STAR® certified monitor.
- EPEAT® registered where applicable. EPEAT registration varies by country. See www.epeat.net for registration status by country.
- RoHS-compliant
- TCO Certified & TCO Certified Edge.
- BFR/PVC free monitor (excluding external cables)
- Meets NFPA 99 leakage current requirements
- Arsenic-free glass and Mercury-free for the panel only

- Monitor with stand
- 1 x Power cable
- 1 x DisplayPort to DisplayPort cable (1.8 m)
- 1 x Super speed USB 5Gbps (USB 3.2 Gen1) Type-A to Type-B upstream cable (enables the USB ports on the monitor)
- Quick Setup Guide
- Safety and regulatory information

PORTS AND SLOTS

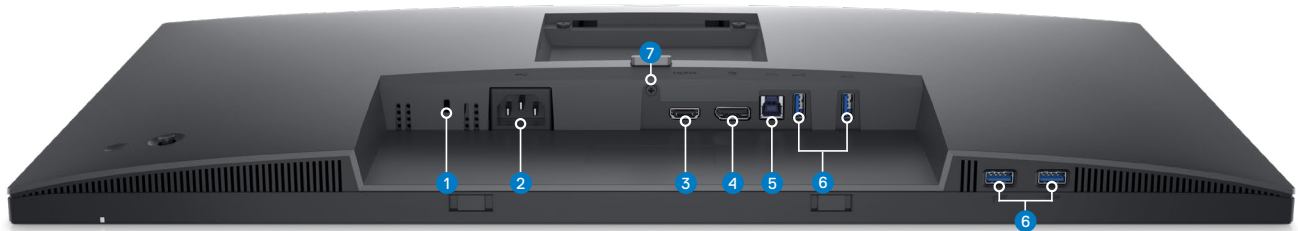

- 1 Security lock slot*
- 2 Power connector
- 3 HDMI port
- 4 DisplayPort

- 5 USB 3.2 Gen1 Upstream port
- 6 SuperSpeed USB 5Gbps (USB 3.2 Gen1) Type-A Downstream port (4)
- 7 Stand lock



* Based on Kensington Security Slot™

Technical specifications subject to change without prior notice. Product availability varies by country. Please contact your Dell representative for more information.

© 2022 Dell Inc. or its subsidiaries. All rights reserved. Dell Technologies, Dell, EMC, Dell EMC and other trademarks are trademarks of Dell Inc. or its subsidiaries. Other trademarks may be trademarks of their respective owners. USB Type-C® and USB-C® are registered trademarks of USB Implementers Forum.

v.1 04/2022